



Model **ds65CR2**



## DynaScan 65" 1080p HD Digital Signage

The DS65CR2 is a large LCD digital signage solution measuring 65" diagonal. Featuring HD native resolution and bright 700 cd/m<sup>2</sup> image, the DS65CR2 is an ideal choice for high impact digital signage. The screen may be installed either portrait or landscape, and is designed for 24/7 operation with a fan cooled design. For even larger applications, the DS65CR2 includes built-in video wall support.

### Key Features

- 1920x1080 HD native resolution
- Portrait / landscape orientation
- All metal construction
- Industrial grade; superior reliability
- Proofing of image retention
- Fan cooled design
- Long life power board design
- VESA mounting compliance
- Carrying handles

# DynaScan 65" 1080p HD Digital Signage

Model **ds65CT2**

LCD PANEL	
LCD Panel Type	65 inches
Native Resolution	1920 x 1080
Brightness	700 cd/m <sup>2</sup>
Contrast Ratio	2500:1 (Typ.)
Response Time	8 ms (Typ.)
Viewing Angle	178° / 178°
Light Life Time	50,000 hrs (Min.)
Panel Surface	3H, HCLR
POWER CONTROL	
Power Supply	Internal
Rated Voltage	100 V ~ 240 V, 50 Hz / 60 Hz
Power On Mode	Max. 520 W
Power Saving Mode	< 1 W
MECHANICAL SPECS (without stand)	
Bezel Width (T/B/L/R mm)	32.8 / 32.8 / 32.8 / 32.8
Cabinet Color	Black
Monitor Dimension (LxHxD mm)	1500 x 875.6 x 123
Monitor Weight (set/package kg)	60 / 63
VESA Mounting (Dimension: mm)	8 Holes (400x400,200x200mm)
AUDIO FEATURES	
Max Audio Output	12 W x 2 ea
SPECIAL FEATURES	
Image Setting	✓
Source/Volume Control	✓
Language	✓ English
Daisy Chain	✓ RS-232 Control
Sharpness Enhancement	✓
Proof of Image Retention	✓
DDC/CI	✓
Dimming Control (DCR)	✓
Picture in Picture (PIP)	✓
De-Interlacing/Comb Filter	✓
10 Bit Color Processing	✓
Built-in Video Wall Support	✓
ID Setting for Daisy Chain	✓
Scheduling	✓
Ambient Light Sensor	✓
Total Turn-on time	✓
Diagnostic DC Voltage (12V/5V)	✓
Internal Temperature Sensor	✓
ACCESSORIES	
Remote Control/AAA Batteries (2)	✓
User's Guide/Driver CD-ROM	✓
VGA Cable	✓
110/220V AC Power Cord	✓
SAFETY & ERGONOMICS	
	FCC/ICES003, CE, CB, ROHS
ENVIRONMENT	
Operating Temperature	0°C ~ 40°C
Storage Temperature	-20°C ~ 60°C
Humidity	10% ~ 80% RH Non-Condensing
Usage	24 hrs / 7 days

All specifications subject to change without notice.

## INTERFACE

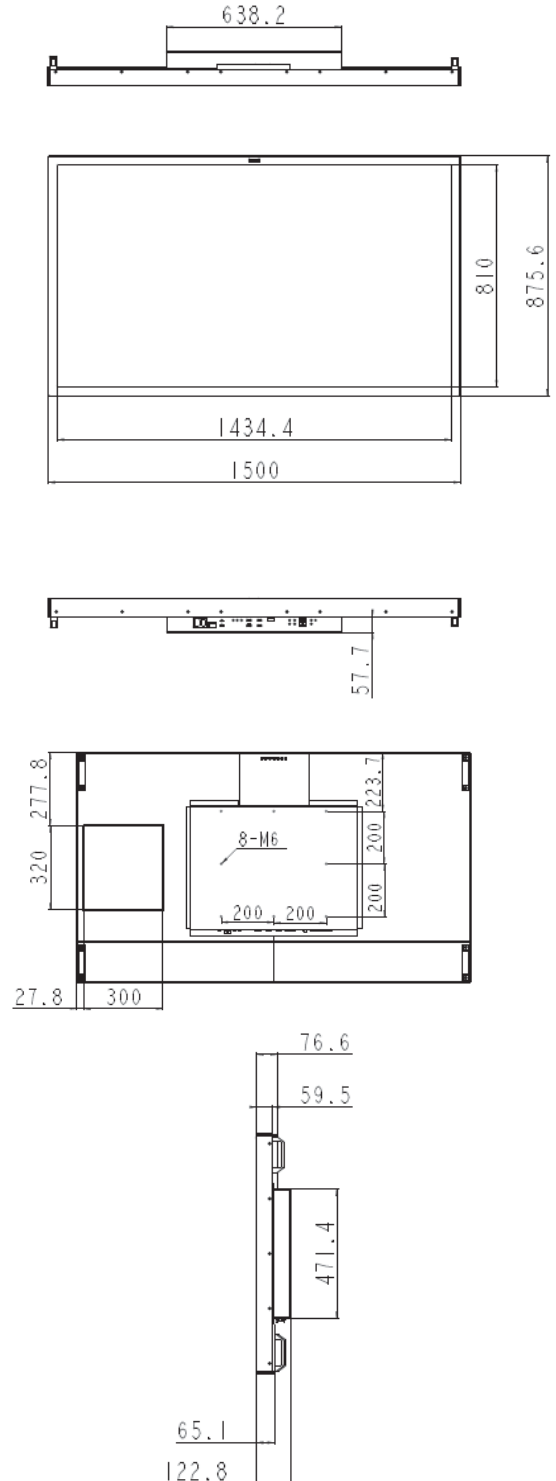

Integrated Display Technology  
 5146 N. Commerce Ave. Suite D  
 Moorpark, CA 93021  
 (805) 334-7014 Phone  
 (805) 334-6687 Fax  
 sales@toshibadisplays.com